

MULTIFLEX AND CASE CONVEYOR CHAINS

The product program offers a wide range of Rexnord multiflex chains and MCC case conveyor chains. These chains are intended for single lane product handling in a variety of applications.

FEATURES

-Multiflex chains

These chains use a unique pivot to connect the hinge pin with the chain link. In standard sideflexing chains the pin and hinge have to deal with horizontal rotation, due to the sideflexing of the chain in the curve, and with vertical rotation of the hinge, when moving over the sprocket. The pivot uncouples these movements, as the hinge pin is only involved in the rotations because of the chain links moving over the sprocket. The pivot can rotate inside the chain link, allowing sideflexing in a curve. Due to the pivot, multiflex chains are ideally suitable for running through multiple curves.

-Armor Clad

The 1700 multiflex chains are also available with a hardened steel cover, the Armor Clad AC 1700 K. Because of this cover the chain is very suitable to convey parts with a high temperature that could damage a plastic chain surface. The steel cover gives the chain an excellent wear life, to make it suitable for part handling in automotive and similar applications.

-Safety

The ZeroGap 1765 and 2565 multiflex chain have a top plate design. The chain surface always stays closed when the chain is running through a curve or over a sprocket. Both chains are commonly used in packaging and automotive industry. The 1710 K and 1713 K multiflex chains also offer surfaces preventing people's fingers to be trapped if larger products have to be conveyed.

-Case conveyor chains

These chains have a very robust design, making them ideally suited for tough applications, such as case and crate handling. They are very open to deal with the often abrasive debris in these kinds of applications. The conveyor design for these chains can be very simple, resulting in a very economic solution for the sometimes very long distances empty or full crates and cases have to be conveyed in a production line.

-Pin design

Both Multiflex and Case Conveyor chains have chain links characterized by two legs. The pins have a special design to prevent opening up of these link legs. This results in a high allowable working load.

- Corner discs

For multiflex and some sideflexing slatband chains, corner discs can be used to reduce the friction in the curves, allowing a multitude of curves within one conveyor. The use of corner discs is mainly found in conveyors with low-speed part handling in dairy applications, automotive part handling, tobacco industry, etc.

The N880 drive corner disc with a toothed contour is used to drive the chain, integrating sprocket and curve function in the corner disc. This means that no return section for the chain is needed, making the conveyor design more simple and economic. In this kind of conveyor design however the amount of pitch elongation due to wear that can be absorbed is limited. The disc is mounted on the drive shafts by means of a clamping device, for which standard machine components can be used.

The carry disc is used in the upper part of the conveyor, contacting the chain in the normal position when it is conveying products. The return disc is used in the return part of the conveyor, contacting the chain when it is in the upside-down position.

The ball bearing types of corner discs are recommended for high-speed and high-load applications; ball bearings are not included. In all other applications corner discs with thermoplastic bushings can be used.

An open corner disc is mounted on the shaft which needs to run through the disc. A closed corner disc is mounted on top of the shaft. Some closed versions, such as 880BO, offer the ability to break out a diaphragm in the closing cap.



MULTIFLEX AND CASE CONVEYOR CHAINS

PROGRAMME

Multiflex and case conveyor chains are available in the following executions:

REXNORD MULTIFLEX CHAINS	
1765	ZeroGap 50 mm pitch chain without gaps if sideflexing or running over a sprocket; low noise and long wear life
2565	ZeroGap 76 mm pitch chain without gaps if sideflexing; heavy duty execution in wear resistant polyamide
1757	1.5" pitch chain with unique top plate design, ideal for extruded aluminum modular conveyor designs, commonly used for part handling applications; also available with rubber top
1700	Basic 50 mm pitch chain when using corner disks; available in 3 versions: standard, with tabs and with hardened steel top surface (AC1700K)
1702	Basic 50 mm pitch chain; bidirectional and FDA-approved for direct food contact
1720	50 mm pitch chain for irregular cardboard containers; bidirectional and smooth edges
1710	1700 Base chain with round top plates for a uniform and continuous surface, also in curves
1713	1700 Base chain with wide top plates riveted to the chain; the links overlap even in tight corners, so there are no gaps causing safety issues
1775	1775 ZeroGap 25mm pitch chain with unique zeroGap plate design, ideal for critical product handling like delicate consumer packaging
MCC CASE CONVEYOR CHAINS	
CC 600	Standard chain; available in straight running and sideflexing executions
CC 631	Standard chain with higher links; available in sideflexing execution; can be supplied with pusher
CC 1400	Reinforced chain; available in straight running and sideflexing executions
CC 1431	Reinforced chain with higher links; available in sideflexing execution

CHAIN TYPE	APPLICATION								
	Standard stable products	Small parts & unstable products	Large & heavy products (industrial)	Wide products	Bi-directional conveyors	Abrasive parts conveying	Incline conveyors	Crate conveying	Finger safety
1700	Best choice					Optional		Optional	
AC 1700						Best choice			
1702	Best choice					Optional		Optional	
1710				Best choice					Optional
1713				Best choice					Optional
1720	Optional	Best choice			Best choice				
1757	Optional	Best choice		Optional			Best choice		
1765 ZeroGap	Optional	Best choice			Best choice	Optional			Best choice
1775 ZeroGap	Optional	Best choice							Best choice
2565			Best choice		Best choice	Optional			Best choice
CC 600/631/1400/1431			Optional				Optional	Best choice	

Best choice

Optional

MULTIFLEX CHAINS



**1765
ZEROGAP™**

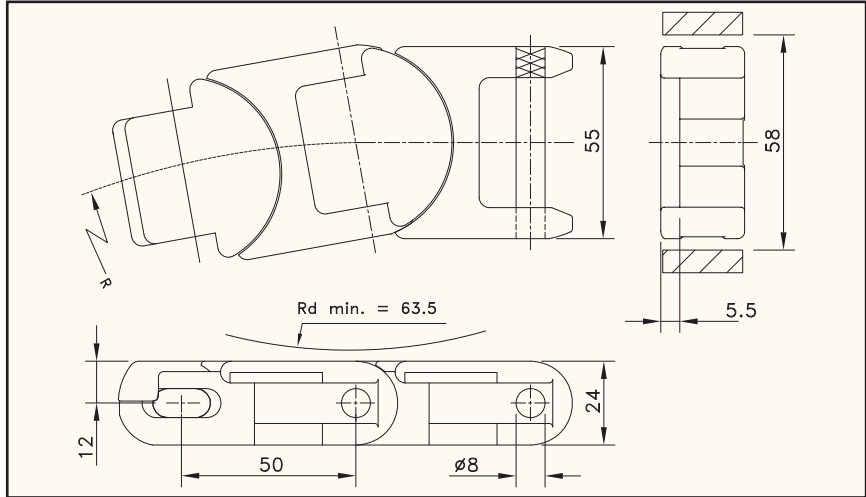

Chain type	Code nr.	Link width A		Weight	Working load (max.)	Backflex radius (min.)	Sideflex radius (min.)
		mm	inch	kg/m	N (21°C)	mm	mm
HP-ACETAL							
HP 1765 ZeroGap	L1765604062N	55.0	2.17	1.46	2670	64	125
WX-POLYAMIDE COMPOSITE							
WX 1765 ZeroGap	L1765654842N1	55.0	2.17	1.46	2670	64	125

Standard length: 3.05 m - 10 feet (61 links)



**2565
HEAVY DUTY**

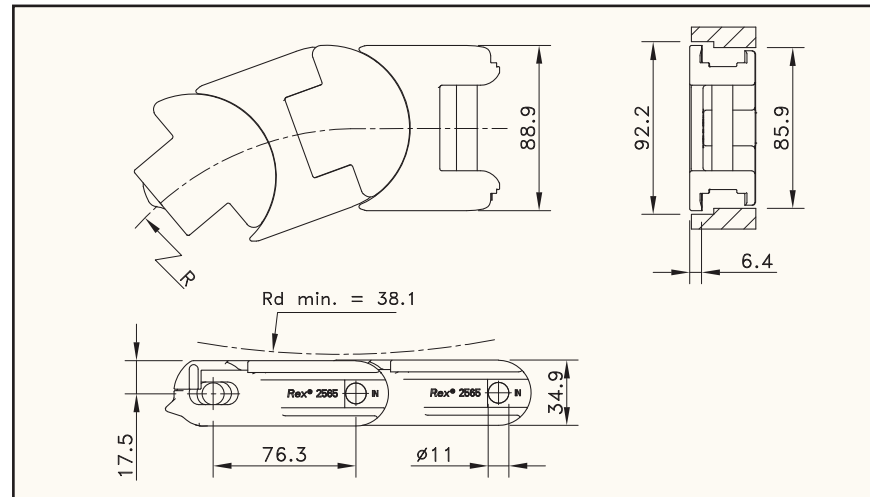

Chain type	Code nr.	Link width A		Weight	Working load (max.)	Backflex radius (min.)	Sideflex radius (min.)
		mm	inch	kg/m	N (21°C)	mm	mm
BWV-POLYAMIDE							
BWV 2565	81432921	88,9	3,50	2,67	10675	89	241

Standard length: 3.048 m - 10 feet (40 links)

MULTIFLEX CHAINS



**1757
TAB**

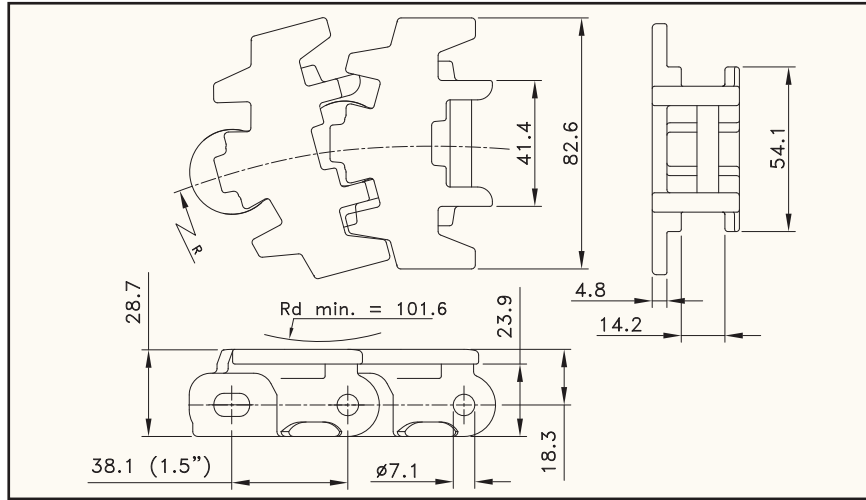

pag. 83

MATERIAL

pag. 213

Chain type	Code nr.	Link width A		Weight	Working load (max.)	Backflex radius (min.)	Sideflex radius (min.)
		mm	inch				
LF-ACETAL							
LF 1757 TAB	81400161	82,6	3,25	1,48	1735	102	152

Standard length: 3.048 m - 10 feet (80 links)



**1757
TAB
WITH RUBBER**

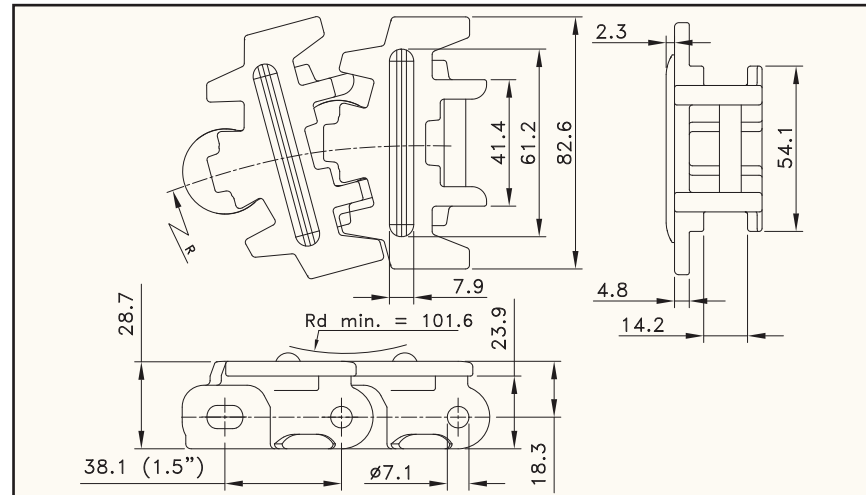

pag. 83

MATERIAL

pag. 213

Chain type	Code nr.	Link width A		Weight	Working load (max.)	Backflex radius (min.)	Sideflex radius (min.)
		mm	inch	kg/m	N (21°C)	mm	mm
HP-ACETAL							
HPM 1757 TAB	81421361*	82,6	3,25	1,48	1735	102	152

Standard length: 3.048 m - 10 feet (80 links)

*Ask Customer service for minimum order quantity of 1757 Chain.

MULTIFLEX CHAINS



1700

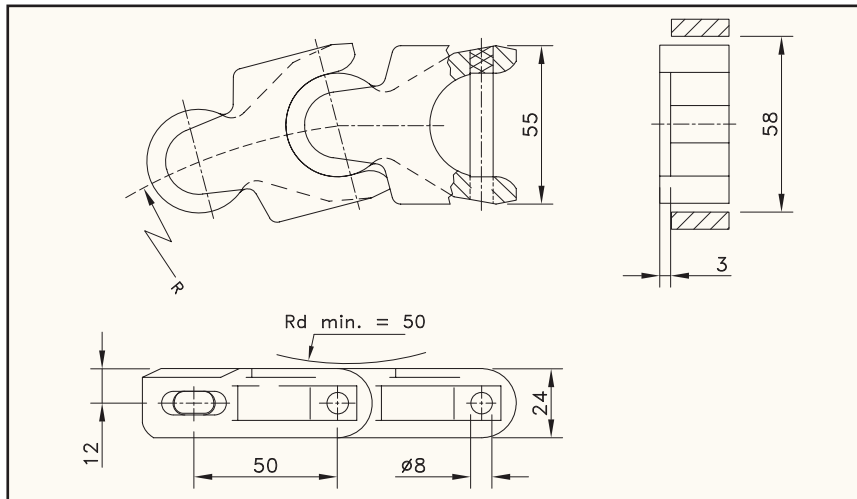

Chain type	Code nr.	Link width A		Weight	Working load (max.)	Backflex radius (min.)	Sideflex radius (min.)
		mm	inch	kg/m	N (21°C)	mm	mm
LF-ACETAL							
A 1700	L1700A	55.0	2.17	1.26	2670	38	140
WLF-ACETAL							
WLF 1700	L1700WLF	55.0	2.17	1.26	2670	38	140
HP-ACETAL							
HP 1700	L1700HP	55.0	2.17	1.26	2670	38	140
ACETAL WITH HARDENED STEEL TOP PLATES							
AC 1700 K	L1700ACK	55.0	2.17	60	2670	38	140

Standard length: 10 m - 32.8 feet (200 links)



AC (ARMOR CLAD) EXECUTION

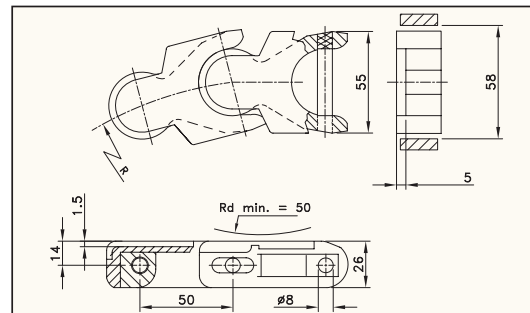

AC (ARMOR CLAD) EXECUTION



**1700
TAB K**

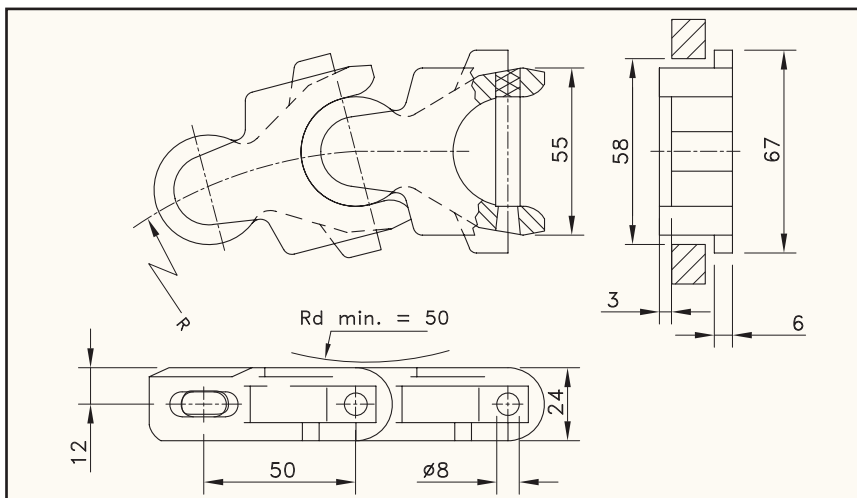

Chain type	Code nr.	Link width A		Weight	Working load (max.)	Backflex radius (min.)	Sideflex radius (min.)
		mm	inch	kg/m	N (21°C)	mm	mm
WLF-ACETAL							
WLF 1700 TAB K	L1700WLFTABK	55.0	2.17	1.30	2670	38	140

Standard length: 10 m - 32.8 feet (200 links)

MULTIFLEX CHAINS



1702

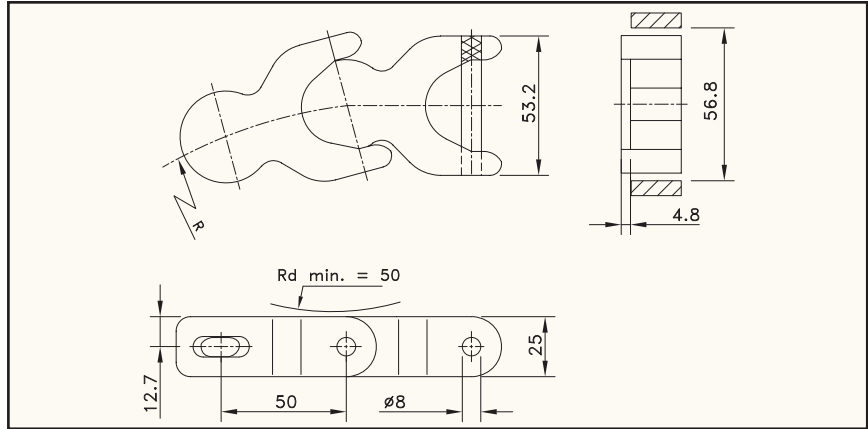

pag. 82,83

MATERIAL

pag. 213

Chain type	Code nr.	Link width A		Weight kg/m	Working load (max.) N (21°C)	Backflex radius (min.) mm	Sideflex radius (min.) mm
		mm	inch				
WLF-ACETAL							
WLF 1702	L1702698592	53.1	2.09	1.43	2670	38	140

Standard length: 3.05 m - 10 feet (61 links)



1720 K

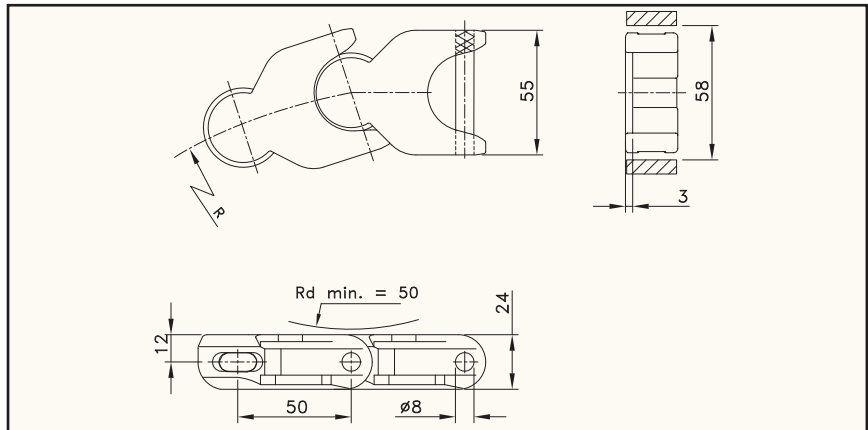

pag. 84



pag. 82,83



pag. 213

Chain type	Code nr.	Link width A		Weight	Working load (max.)	Backflex radius (min.)	Sideflex radius (min.)
		mm	inch	kg/m	N (21°C)	mm	mm
HP-ACETAL							
HP 1720	L1720HP	55.0	2.17	1.26	2600	50	140

Standard length: 10 m - 32.8 feet (200 links)



1775 ZEROGAP

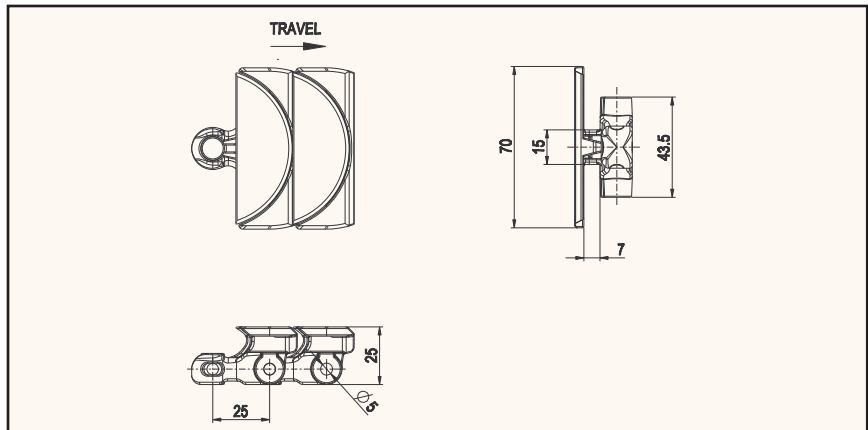

pag. 84



pag. 82,83



pag. 213

Chain type	Code nr.	Link width A		Weight	Working load (max.)	Backflex radius (min.)	Sideflex radius (min.)
		mm	inch	kg/m	N (21°C)	mm	mm
HP-ACETAL							
HP®1775	L1775634993	70.0	2.76	1.05	1000	80	150

Standard length: 5 m - 16.4 ft (200 pitches)

MULTIFLEX CHAINS

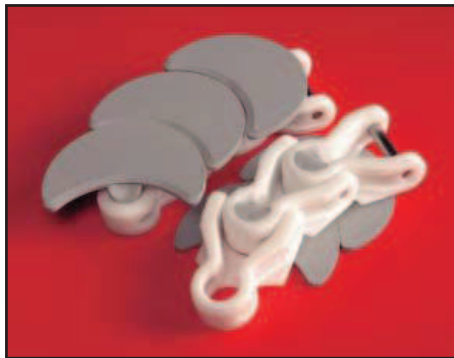

1710 K

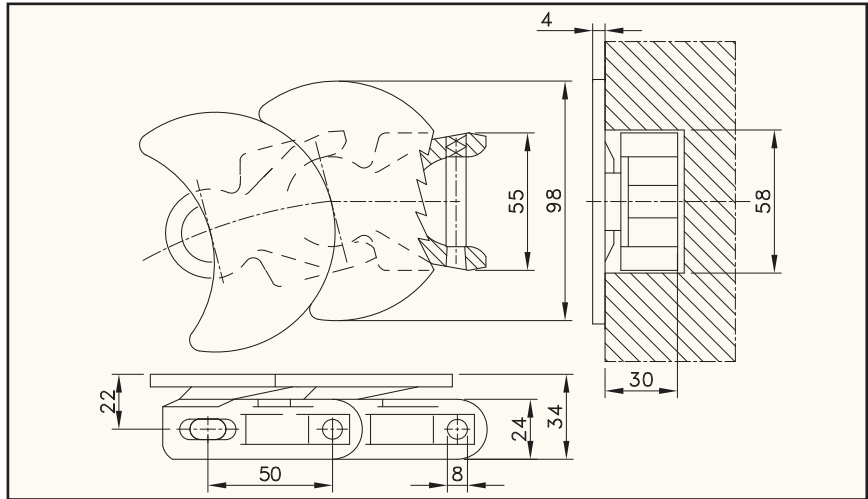

Chain type	Code nr.	Link width A		Weight	Working load (max.)	Backflex radius (min.)	Sideflex radius (min.)
		mm	inch	kg/m	N (21°C)	mm	mm
WLF-ACETAL							
WLF 1710 K	L1710WLFK	98.0	3.86	1.88	2600	0	140

Standard length: 10 m - 32.8 feet (200 links). Top plate grey polyamide.



1710 TAB K

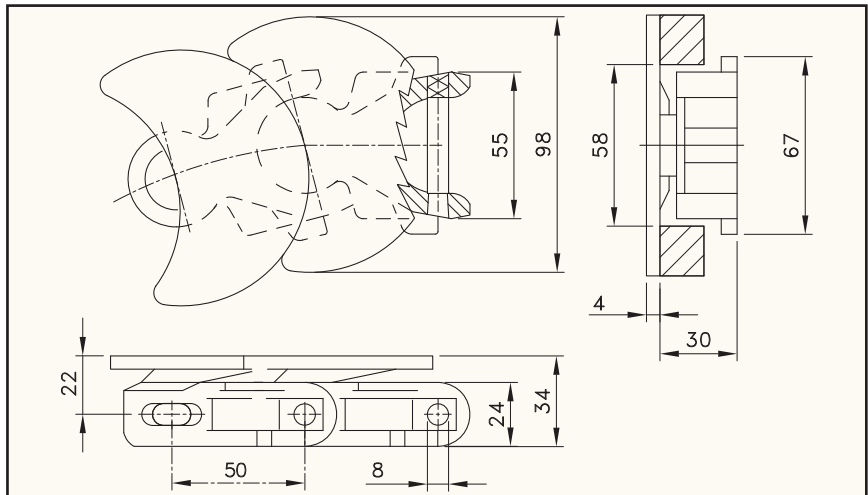

Chain type	Code nr.	Link width A		Weight	Working load (max.)	Backflex radius (min.)	Sideflex radius (min.)
		mm	inch	kg/m	N (21°C)	mm	mm
WLF-ACETAL							
WLF 1710 TAB K	L1710WLFTABK	98.0	3.86	1.93	2600	0	140

Standard length: 10 m - 32.8 feet (200 links). Top plate grey polyamide.

MULTIFLEX CHAINS



1713 K

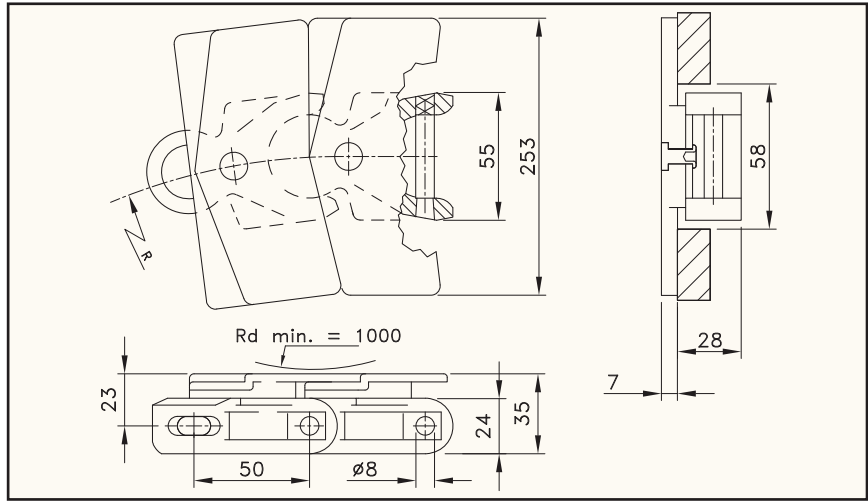

Chain type	Code nr.	Link width A		Weight	Working load (max.)	Backflex radius (min.)	Sideflex radius (min.)
		mm	inch	kg/m	N (21°C)	mm	mm
WLF-ACETAL							
WLF 1713 K	L1713WLFK	253.0	9.96	2.70	2600	1000	500

Standard length: 10 m - 32.8 feet (200 links). Top plate white acetal.



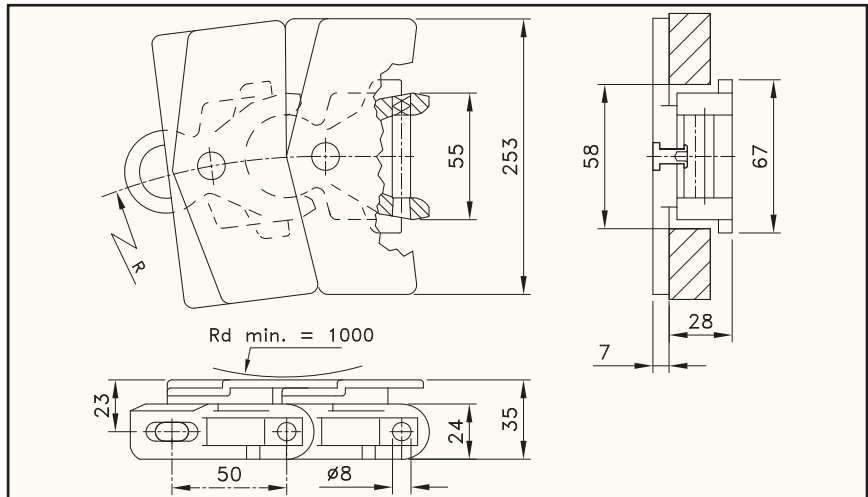

1713 TAB K



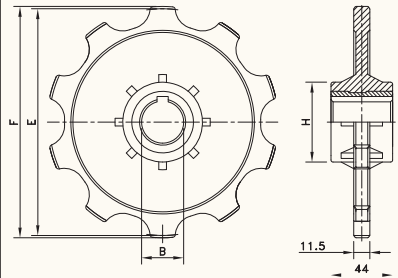

Chain type	Code nr.	Link width A		Weight	Working load (max.)	Backflex radius (min.)	Sideflex radius (min.)
		mm	inch	kg/m	N (21°C)	mm	mm
WLF-ACETAL							
WLF 1713 TAB K	L1713WLFTABK	253.0	9.96	2.75	2600	1000	500

Standard length: 10 m - 32.8 feet (200 links). Top plate white acetal.

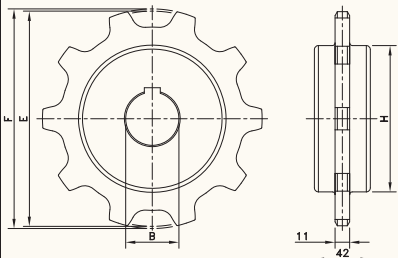

SPROCKETS FOR MULTIFLEX CHAINS

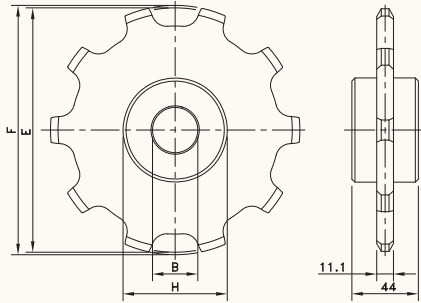
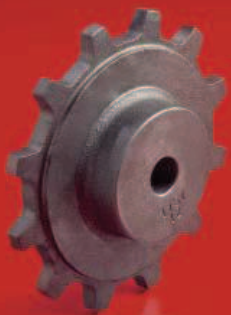
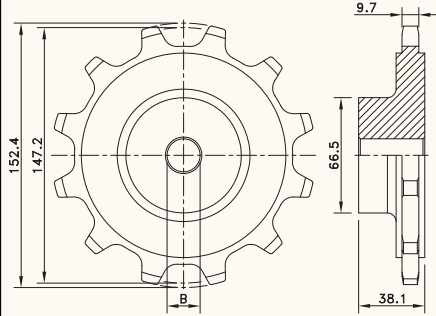
Sprocket type	Code nr.	Nr. of teeth	Bore B mm	Pitch diameter E mm	Outside diameter F mm	Width (Teeth/ Ring) mm	Hub width mm	Hub diameter H mm	MATERIAL pag. 214
CLASSIC PLASTIC SPROCKETS, INJECTION MOULDED, BRASS HUB - N 1700									
METRIC BORES									
N1700 10-24	L1700661391	10	24	161.8	165.1	11.1	44.0	57	
N1700 10-25	L1700661381	10	25						
N1700 10-30	L1700661401	10	30						
For Multiflex chain series: 1700, 1702, 1710, 1713, 1720, 1765									
CLASSIC PLASTIC IDLER, INJECTION MOULDED - NX 1700									
METRIC BORE									
NX1700 10-25	L1700661411	10	25	161.8	165.1	11.1	43.0	50	
For Multiflex chain series: 1700, 1702, 1710, 1713, 1720, 1765									
CLASSIC PLASTIC SPROCKETS, MACHINED - KU 1700									
METRIC BORES									
KU1700 08-19	L1700668341	8	19	130.7	132.8	11.1	42.0	79	
KU1700 08-25	L1700613242	8	25						
KU1700 08-30	L1700630842	8	30						
KU1700 10-19	L1700668351	10	19	161.8	165.1	11.1	42.0	110	
KU1700 10-25	L1700602806	10	25						
KU1700 10-30	L1700618392	10	30						
KU1700 13-19	L1700668361	13	19	209.0	215.2	11.1	42.0	158	
For Multiflex chain series: 1700, 1702, 1710, 1713, 1720, 1765									

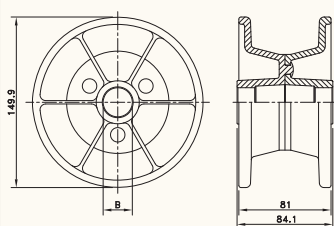
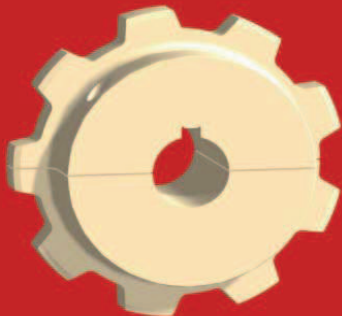
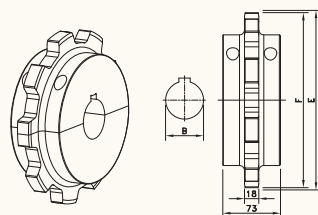
SPROCKETS FOR MULTIFLEX CHAINS

Sprocket type	Code nr.	Nr. of teeth	Bore B	Pitch diameter E	Outside diameter F	Width (Teeth/ Ring)	Hub width	Hub diameter H	MATERIAL pag. 214		
			mm	mm	mm	mm	mm	mm			
CLASSIC ZINC PLATED STEEL IDLERS - ZN 1700											
METRIC BORES											
ZN1700 10-20	L1700661421	10	20	161.8	165.1	11.1	44.0	69.0			
ZN1700 12-20	L1700661431	12	20	193.2	196.1						
For Multiflex chain series: 1700, 1702, 1710, 1713, 1720, 1765											
											
CLASSIC SEMI-STEEL SPROCKET, EXCENTERED HUB - GG 1757											
INCH BORE											
GG1757 12- 3/4 prebore	414-36-2	12	0.750"	147.2	152.4	9.7	38.1	66.5			
For Multiflex chain series: 1757											
											
CLASSIC PLASTIC IDLER DRUM, INJECTION MOULDED - NXT 1757											
METRIC BORE											
NXT1757 10-25	614-25-1	10	25	-	149.9	81	84.1	38.1			
For Multiflex chain series: 1757											
											
SPLIT PLASTIC SPROCKETS, INJECTION MOULDED – KUS 2500											
METRIC BORE											
KUS 2500 T09 R50	614-681-8	9	50	222.8	221.2	18.0	73.0	165.0			
For Multiflex chain series: 2565											
											

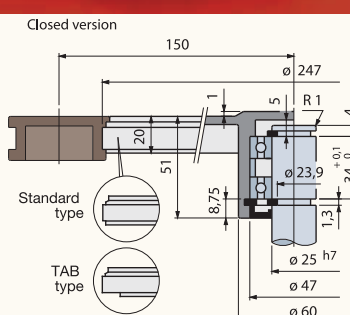
CORNER DISCS FOR MULTIFLEX CHAINS

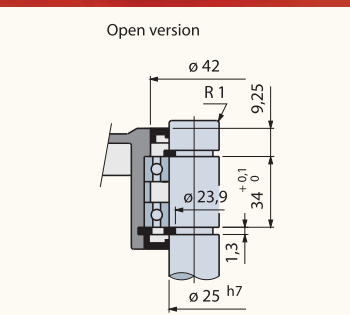
Corner disc type	Code nr.	Execution	Open/ closed	Pitch diameter chain	Outside diameter	Weight	<div>MATERIAL</div> <div>pag. 214</div>
				mm	mm	kg	
FOR PLASTIC MULTIFLEX CHAINS 1700 K, 1710 K, 1720 K AND 1765 ZEROGAP							
STANDARD							
ND1700BC-TR	L1700669701	carry	closed	300	247	0.70	
ND1700BO-TR	L1700669721	carry	open				
ND1700BC-RET	L1700669611	return	closed				
ND1700BO-RET	L1700669641	return	open				
- prepared for 2x single race ball bearing (25x47x12 mm)							
WITH 4 HOLES ON BOTTOM FOR PUSHERS							
ND1700-TR	L1700669561	carry	open	300	247	0.47	
ND1700-RET	L1700669591	return	open				
- plastic bushing diameter ø25 mm							
WITH FLANGES (ø355)							
ND1700FL-TR	L1700689461	carry	open	300	247	0.92	
ND1700FL-RET	L1700609602	return	open				
- plastic bushing diameter ø25 mm							
FOR PLASTIC MULTIFLEX CHAINS 1700 TAB K AND 1710 TAB K							
STANDARD							
ND1700TBC-TR	L1700669741	carry	closed	300	247	0.70	
ND1700TBO-TR	L1700669761	carry	open				
ND1700TBC-RET	L1700669661	return	closed				
ND1700TBO-RET	L1700669681	return	open				
- prepared for 2x single race ball bearing (25x47x12 mm)							
WITH 4 HOLES ON BOTTOM FOR PUSHERS							
ND1700T-TR	L1700669571	carry	open	300	247	0.47	
ND1700T-RET	L1700669601	return	open				
- plastic bushing diameter ø25 mm - holes ø 8.5 mm							

PLASTIC CASE CONVEYOR CHAINS



**STRAIGHT RUN
WITHOUT TABS**

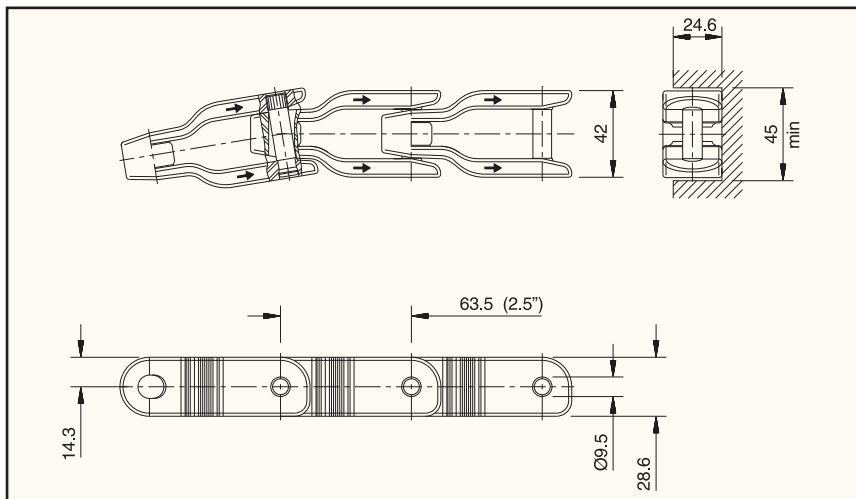

MATERIAL
pag. 213

Chain type	Code nr.	Link width		Weight	Working load (max.)	Backflex radius (min.)	Sideflex radius (min.)
		A					
		mm	inch	kg/m	N (21°C)	mm	mm
XL-ACETAL							
CC 600 XL	752.72.05	42.0	1.66	1.20	3950	50	457
NC-ACETAL							
CC 600 NC	752.75.05	42.0	1.66	1.20	3950	50	457
WPP-POLYPROPYLENE							
CC 600 WPP	752.77.05*	42.0	1.66	1.00	1975	50	457

Standard length: 3.048 m - 10 feet (48 links)

*Ask customer service for minimum order quantity.



**SIDEFLEX
WITH TABS**

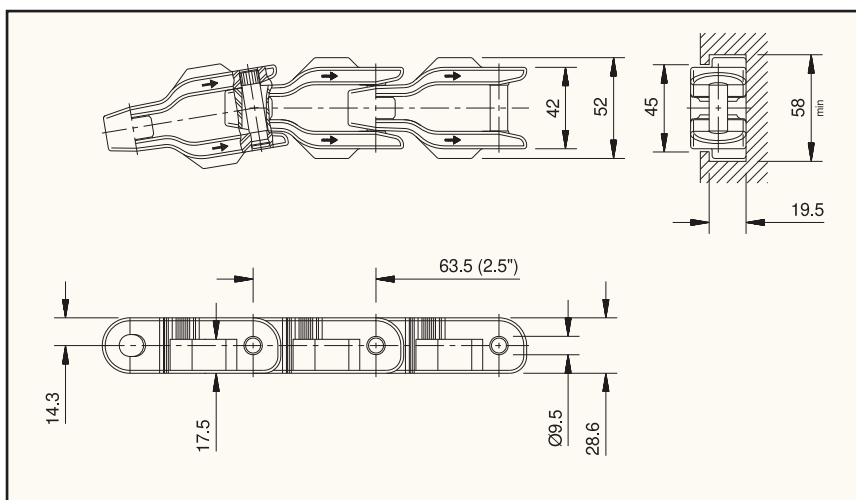

MATERIAL
pag. 213

Chain type	Code nr.	Link width		Weight	Working load (max.)	Backflex radius (min.)	Sideflex radius (min.)
		A					
		mm	inch	kg/m	N (21°C)	mm	mm
XL-ACETAL							
CC 600 TXL	752.72.04	42.0	1.66	1.25	3950	50	457
NC-ACETAL							
CC 600 TNC	752.75.04	42.0	1.66	1.25	3950	50	457
WPP-POLYPROPYLENE							
CC 600 TWPP	752.77.04*	42.0	1.66	1.03	1975	50	457

Standard length: 3.048 m - 10 feet (48 links)

*Ask customer service for minimum order quantity.

PLASTIC CASE CONVEYOR CHAINS



**SIDFLEX
WITH TABS
WITH HIGHER LINK**

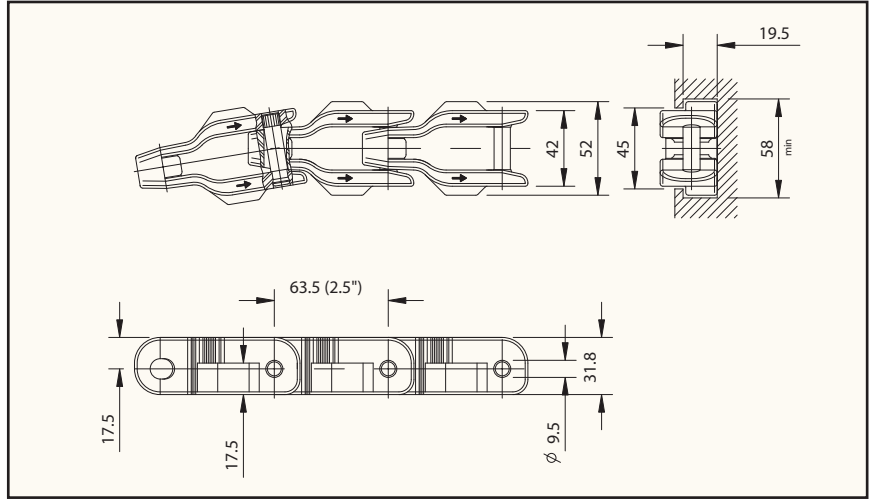

Chain type	Code nr.	Link width		Weight	Working load (max.)	Backflex radius (min.)	Sideflex radius (min.)
		A					
		mm	inch	kg/m	N (21°C)	mm	mm
XL-ACETAL							
CC 631 TXL	752.42.04	42.0	1.66	1.35	3950	50	457
NC-ACETAL							
CC 631 TNC	752.45.04*	42.0	1.66	1.35	3950	50	457

Standard length: 3.048 m - 10 feet (48 links)

*Ask customer service for minimum order quantity.

PLASTIC CASE CONVEYOR CHAINS



**STRAIGHT RUN
REINFORCED
WITHOUT TABS**

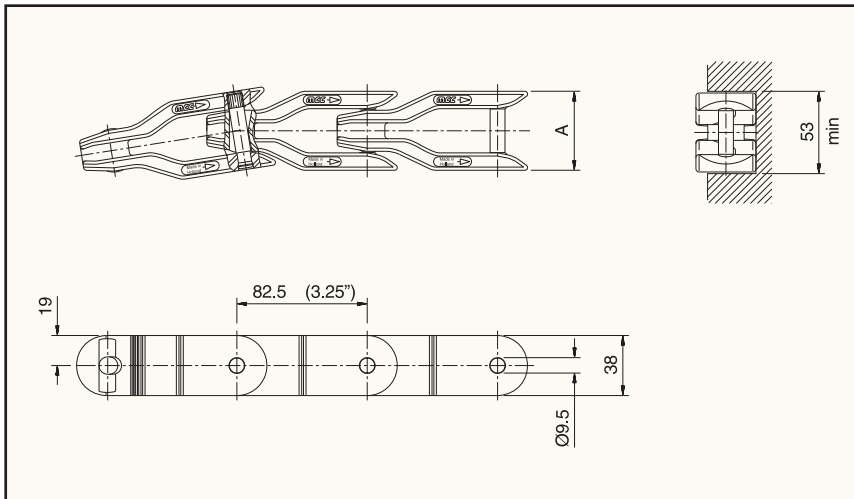

MATERIAL
pag. 213

Chain type	Code nr.	Link width		Weight	Working load (max.)	Backflex radius (min.)	Sideflex radius (min.)
		A					
		mm	inch	kg/m	N (21°C)	mm	mm
XL-ACETAL							
CC 1400 XL	752.32.05	50.0	1.97	1.70	6500	50	660
NC-ACETAL							
CC 1400 NC	752.35.05	50.0	1.97	1.70	6500	50	660

Standard length: 3.053 m - 10 feet (37 links)



**SIDEFLEX
REINFORCED
WITH TABS**

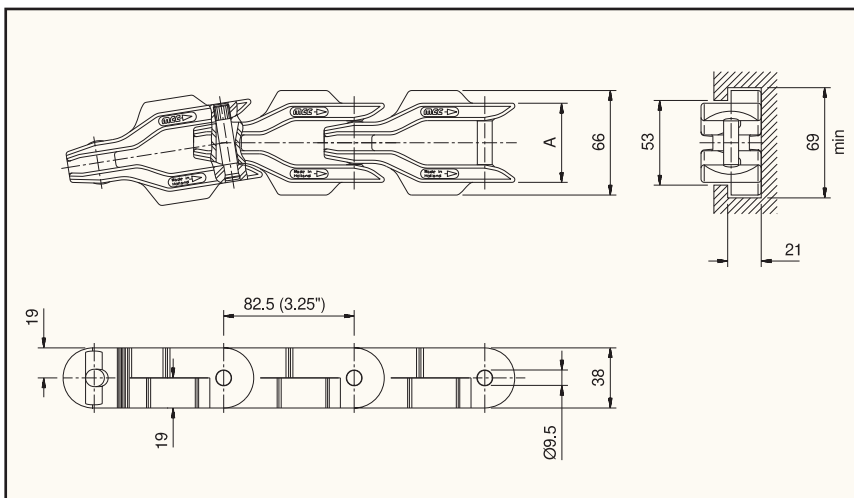

MATERIAL
pag. 213

Chain type	Code nr.	Link width		Weight	Working load (max.)	Backflex radius (min.)	Sideflex radius (min.)
		A					
		mm	inch	kg/m	N (21°C)	mm	mm
XL-ACETAL							
CC 1400 TXL	752.32.04	50.0	1.97	1.75	6500	50	660
NC-ACETAL							
CC 1400 TNC	752.35.04	50.0	1.97	1.75	6500	50	660

Standard length: 3.053 m - 10 feet (37 links)

PLASTIC CASE CONVEYOR CHAINS



**SIDEFLEX
REINFORCED
WITH TABS WITH HIGHER LINK**

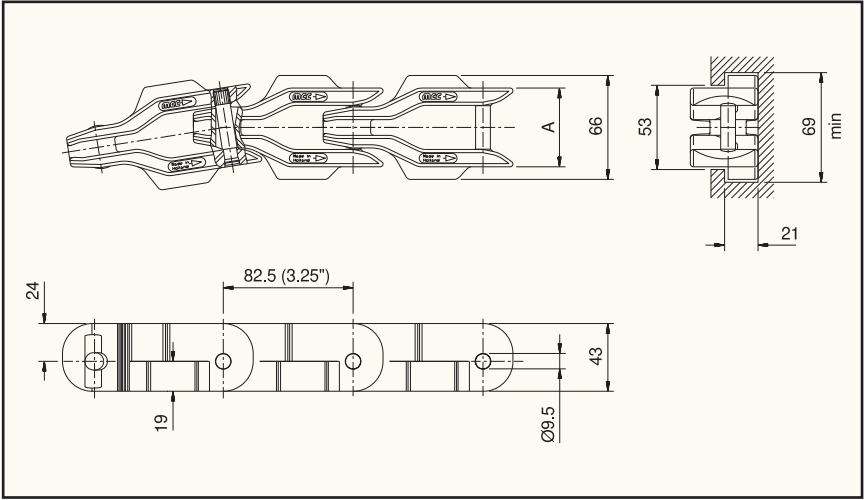



pag. 89

MATERIAL

pag. 213

Chain type	Code nr.	Link width		Weight	Working load (max.)	Backflex radius (min.)	Sideflex radius (min.)
		A					
		mm	inch	kg/m	N (21°C)	mm	mm
XL-ACETAL							
CC 1431 TXL	752.92.04	50.0	1.97	2.02	6500	50	660
NC-ACETAL							
CC 1431 TNC	752.95.04	50.0	1.97	2.02	6500	50	660

Standard length: 3.053 m - 10 feet (37 links)
* Ask customer service for minimum order quantity of CC1431 TBL chains.

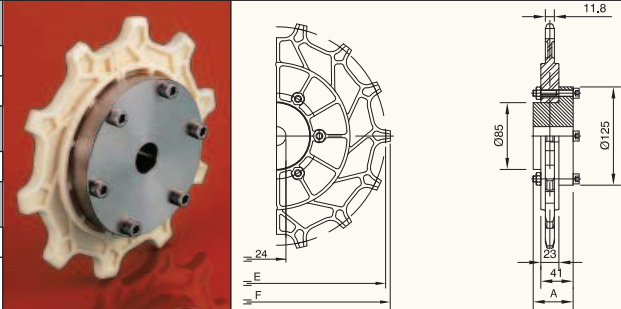
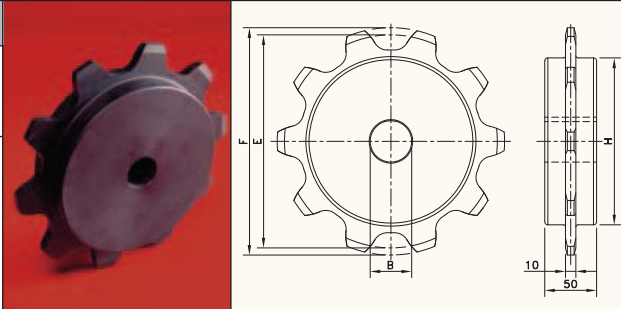
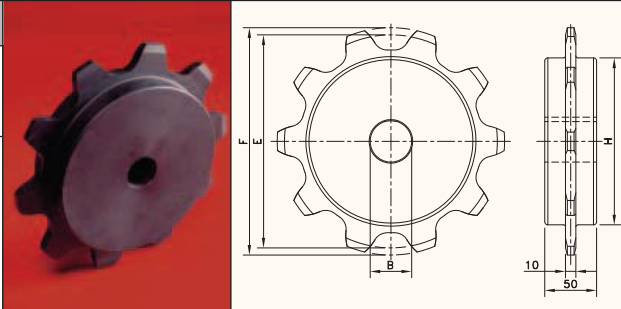
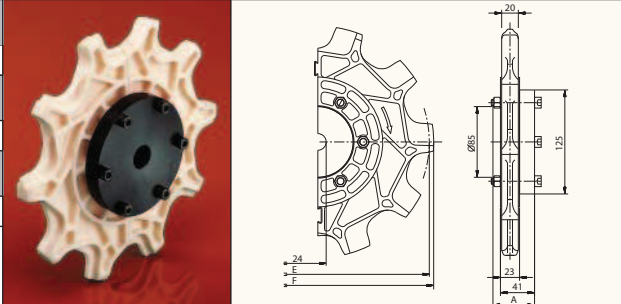

SPROCKETS FOR CASE CONVEYOR CHAINS

Type	Code nr.	Nr. of teeth	Bore B mm	Pitch diameter E mm	Outside diameter F mm	Hub width A mm	MATERIAL pag. 214
SEMI-SPLIT SPROCKETS FOR CC600/631							
SPROCKET RING SET							
SR CC600 10	753.83.62	10	-	205.5	209.4	-	
SR CC600 14	753.83.65	14	-	285.4	289.8	-	
CARBON STEEL HUB							
CH CC-C 24	753.78.62	-	24	-	-	50	
STAINLESS STEEL HUB							
CH CC-S 24	753.78.61	-	24	-	-	50	
The split sprocket rings and unsplit hubs are supplied separately, so that the hub doesn't need to be replaced in case of wear of the sprocket rings.							
CLASSIC SPROCKETS FOR CC600/631							
METRIC BORES							
KU 600 06-20	L0600699111	6	20	127.0	128.0	50	
KU 600 08-20	L0600604046	8	20	165.9	177.7		
KU 600 10-20	L0600605916	10	20	205.5	219.3		
SEMI-SPLIT SPROCKETS FOR CC1400/1431							
SPROCKET RING SET							
SR CC1400 10	753.83.42	10	-	267.0	278.4	-	
CARBON STEEL HUB							
CH CC-C 24	753.78.62	-	24	-	-	50	
STAINLESS STEEL HUB							
CH CC-S 24	753.78.61	-	24	-	-	50	
The split sprocket rings and unsplit hubs are supplied separately, so that the hub doesn't need to be replaced in case of wear of the sprocket rings.							