

DN			Article Code Orobica P.G.	D +0/-0,2	d +0,2/-0	d1 +0,2/-0	S +0,2/-0	S1	S2
E DIN	SMS								
(1.3)	(1.2)	(1.3)							
		25	056.2200	32,0	22,5	25,0	5,5	2,0	3,5
	25		056.2025	32,0	25,0		5,5		
25			056.4025	37,0	28,0	32,0	6,0	4,0	2,0
	32		056.2032	40,0	32,0		5,5		
32			056.4032	45,0	36,0	40,0	6,0	4,0	2,0
		38	056.2210	48,0	35,5	38,0	5,5	2,0	3,5
	40		056.2040	48,0	38,0		5,5		
40			056.4040	57,0	45,0	50,0	6,0	4,0	2,0
		51	056.2220	61,0	48,5	51,0	5,5	2,0	3,5
	50		056.2050	61,0	51,0		5,5		
50			056.4050	68,0	56,0	60,0	6,0	4,0	2,0
		63	056.2230	73,5	60,5	63,5	5,5	2,0	3,5
	65		056.2065	73,5	63,5		5,5		
65			056.4065	81,0	67,0	75,0	6,0	4,0	2,0
		76	056.2240	86,0	72,9	76,0	5,5	2,0	3,5
	80		056.2080	86,0	76,0		5,5		
80			056.4080	96,0	83,0	90,0	6,0	4,0	2,0
	100		056.2100	113,5	101,6		5,5		
100			056.4100	114,0	98,0	111,0	6,0	4,0	2,0
		104	056.2250	116,0	100,0	104,0	5,5	2,0	3,5
125			056.4125	148,0	126,0	140,0	6,0	4,0	2,0

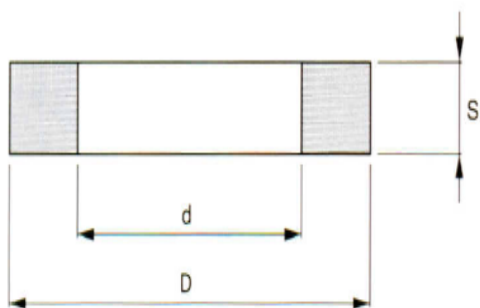

Figure (1.2)

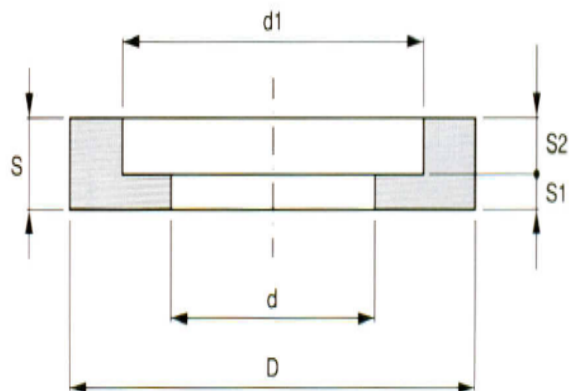

Figure (1.3)