

DN		Article Code Orobica P.G.	C2 (c/c)		C4 (id)		S (od)		E (od)		De (od)	
Inch	mm		Inch +0/-0,02	mm +0/-0,5	Inch +0,02/-0	mm +0,5/-0	Inch ±0,02	mm ±0,5	Inch +0/-0,02	mm +0/-0,5	Inch ±0,02	mm ±0,5
1/4"	12.00	056.1500	1,083	27,50	0,402	10,20	1,339	34,00			1,425	36,20
1/2"	12.70	056.1503	1,083	27,50	0,429	10,90	1,339	34,00			1,425	36,20
3/4"	17.20	056.1506	1,083	27,50	0,606	15,40	1,339	34,00			1,425	36,20
3/8"	21.30	056.1510	1,083	27,50	0,768	19,50	1,339	34,00			1,425	36,20
1"	25.00	056.8200	1,713	43,50	0,898	22,80			1,988	50,50	2,075	52,70
		056.1520	1,713	43,50	0,898	22,80	1,988	50,50				
1" 1/8	33.70	056.8212	1,713	43,50	1,240	31,50			1,988	50,50	2,075	52,70
		056.1521	1,713	43,50	1,240	31,50	1,988	50,50				
1" 1/2	38.10	056.8210	1,713	43,50	1,409	35,80			1,988	50,50	2,075	52,70
		056.1530	1,713	43,50	1,409	35,80	1,988	50,50				
1" 3/4	40.00	056.8215	2,224	56,50	1,488	37,80			2,520	64,00	2,606	66,20
		056.1522	2,224	56,50	1,488	37,80	2,520	64,00				
2"	51.00	056.8220	2,224	56,50	1,921	48,80			2,520	64,00	2,606	66,20
		056.1540	2,224	56,50	1,921	48,80	2,520	64,00				
2" 1/2	63.50	056.8230	2,776	70,50	2,382	60,50			3,051	77,50	3,138	79,70
		056.1550	2,776	70,50	2,382	60,50	3,051	77,50				
2" 3/4	70.00	056.8235	3,287	83,50	2,638	67,00			3,583	91,00	3,669	93,20
		056.1555	3,287	83,50	2,638	67,00	3,583	91,00				
3"	76.10	056.8240	3,287	83,50	2,878	73,10			3,583	91,00	3,669	93,20
		056.1560	3,287	83,50	2,878	73,10	3,583	91,00				
3" 1/2	88.90	056.8245	3,819	97,00	3,350	85,10			4,173	106,00	4,260	108,20
		056.1565	3,819	97,00	3,350	85,10	4,173	106,00				
4"	101.60	056.8250	4,331	110,00	3,850	97,80			4,685	119,00	4,772	121,20
		056.1570	4,331	110,00	3,850	97,80	4,685	119,00				
4" 1/2	114.30	056.8252	3,803	122,00	4,350	110,50			5,118	130,00	5,205	132,20
		056.1575	3,803	122,00	4,350	110,50	5,118	130,00				
5" 1/2	139.70	056.8255	5,748	146,00	5,350	135,90			6,102	155,00	6,189	157,20
		056.1580	5,748	146,00	5,350	135,90	6,102	155,00				
6"	168.30	056.8260	6,850	174,00	6,429	163,30			7,205	183,00	7,291	185,20
		056.1585	6,850	174,00	6,429	163,30	7,205	183,00				
8"	219.10	056.8265	8,858	225,00	8,429	214,10			9,193	233,50	9,280	235,70
		056.1588	8,858	225,00	8,429	214,10	9,193	233,50				

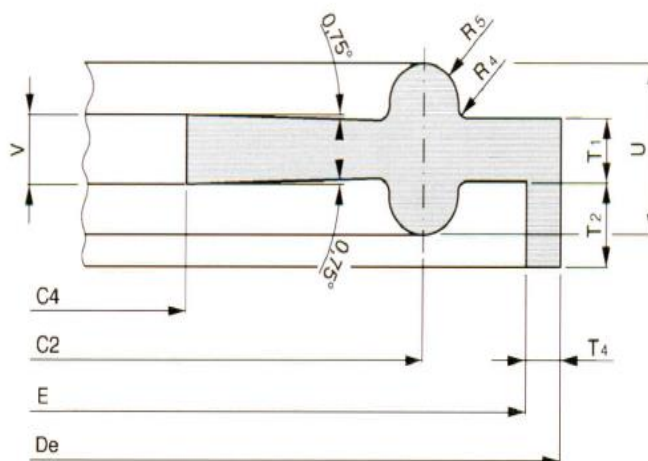
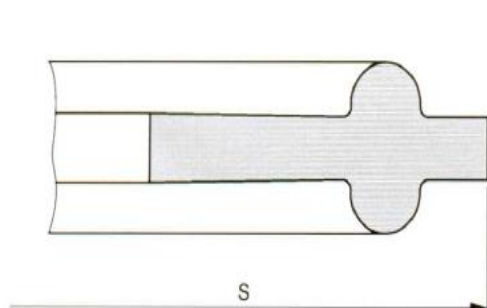

$$\begin{aligned}
 T_4 &= 1,1 \pm 0,2 \\
 U &= 5,5 \pm 0,2 \\
 T_1 &= 1,7^{+0,25}_0 \\
 R_4 &= 0,4 \\
 R_5 &= 1,2 \\
 V &= 2,1^{+0,25}_0 \\
 T_2 &= 2,8 \pm 0,3
 \end{aligned}$$